

* PLANS AND ELEVATIONS SHOWN ARE A GRAPHIC INTERPRETATION AND ARE SUBJECT TO CHANGE WITHOUT NOTICE.

* CONSULT BUILDERS PLANS FOR ACTUAL CONSTRUCTION DETAILS AND SIZES.

"THE KESWICK"



FRONT ELEVATION

\$307,950

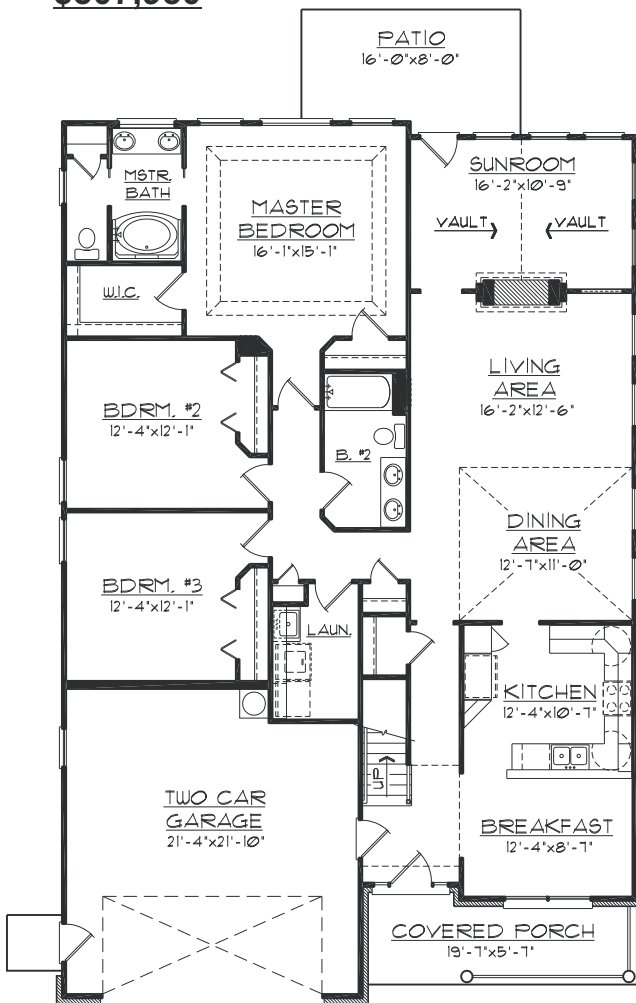

FIRST FLOOR PLAN OPTION "A"
(BREAKFAST AREA PLAN)

This option includes Hardwood Floors in the: Foyer, Dining Room, Kitchen, and Living Area

\$314,950

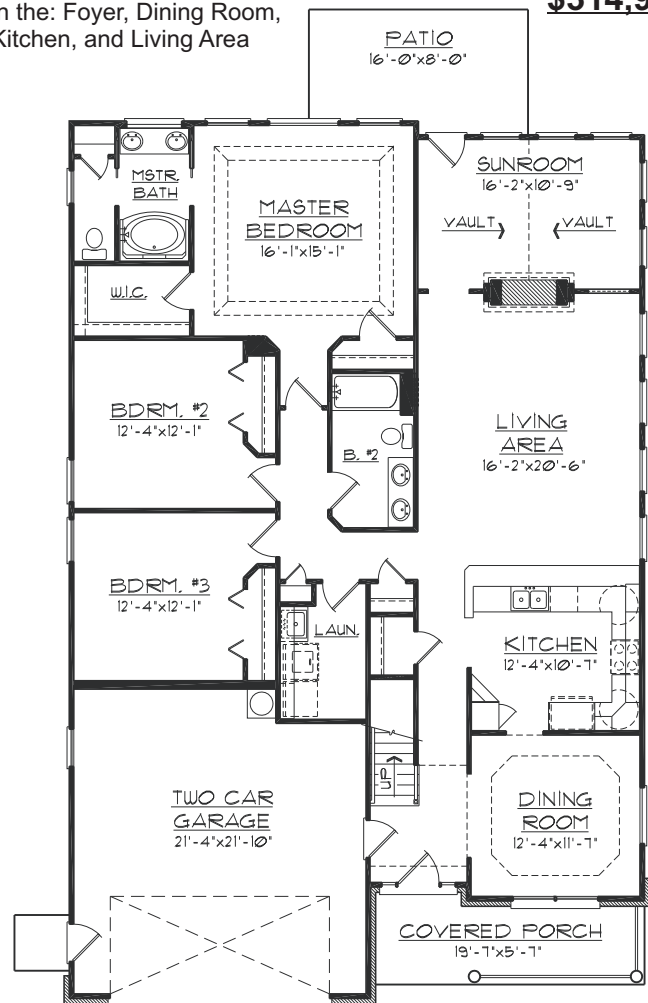

FIRST FLOOR PLAN OPTION "B"
(FORMAL DINING ROOM PLAN)

1st FLOOR:	2015 SQ. FT.
GARAGE:	468 SQ. FT.

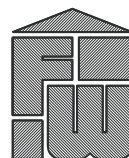

FRALIN and WALDRON, INC.
ROANOKE, VIRGINIA

"THE KESWICK" FIRST FLOOR PLAN OPTIONS.

"THE KESWICK"

• PLANS AND ELEVATIONS SHOWN ARE A GRAPHIC INTERPRETATION AND ARE SUBJECT TO CHANGE WITHOUT NOTICE.
 • CONSULT BUILDERS PLANS FOR ACTUAL CONSTRUCTION DETAILS AND SIZES.

+\$24,000

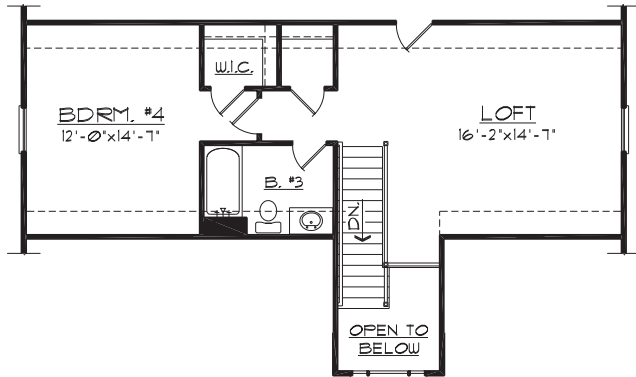

SECOND FLOOR PLAN OPTION "A"

FINISHED AREA: 601 SQ. FT.

+\$17,000

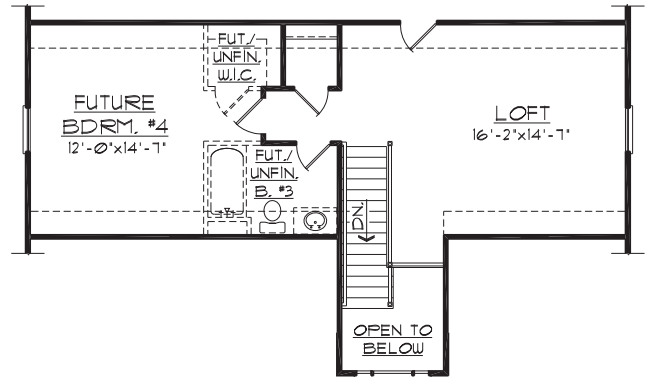

SECOND FLOOR PLAN OPTION "B"

FINISHED AREA: 322 SQ. FT.
 UNFIN. AREA: 279 SQ. FT.

+\$6,000

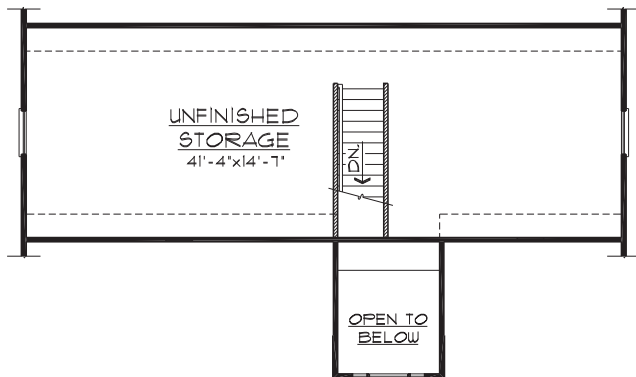

SECOND FLOOR PLAN OPTION "C"

UNFIN. AREA: 579 SQ. FT.

+\$3,500

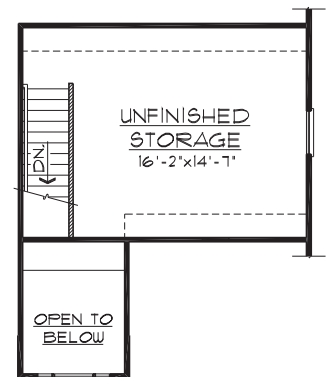

SECOND FLOOR PLAN OPTION "D"

UNFIN. AREA: 259 SQ. FT.

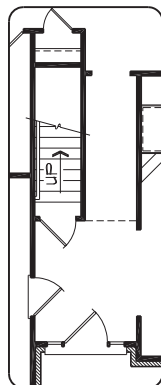

OPTIONAL ENCLOSED STAIRS
 (REQUIRED FOR SECOND FLOOR
 OPTIONS "C" AND "D")

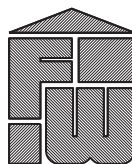

FRALIN and WALDRON, INC.
 ROANOKE, VIRGINIA

"THE KESWICK" SECOND FLOOR
 PLAN OPTIONS.

* PLANS AND ELEVATIONS SHOWN ARE A GRAPHIC INTERPRETATION AND ARE SUBJECT TO CHANGE WITHOUT NOTICE.

* CONSULT BUILDERS PLANS FOR ACTUAL CONSTRUCTION DETAILS AND SIZES.

"THE KESWICK"

Standard

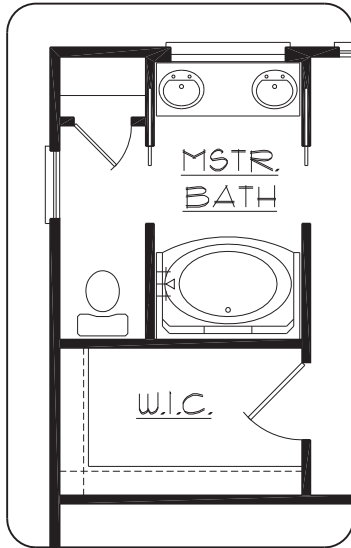

MASTER BATH PLAN OPTION "A"
(FIBERGLASS SOAKING TUB/
SHOWER COMBINATION)

+\$600

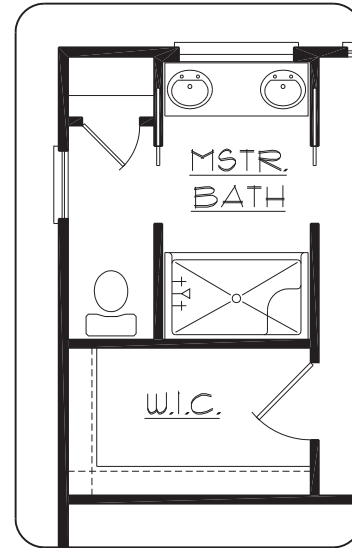

MASTER BATH PLAN OPTION "B"
(FIBERGLASS WALK IN SHOWER)

+\$5,000

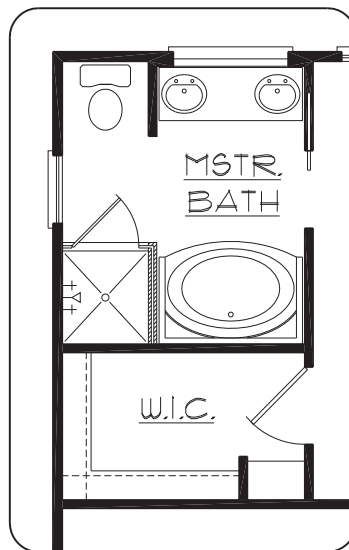

MASTER BATH PLAN OPTION "C"
(CERAMIC TILE SHOWER wt. GLASS
ENCLOSURE & FIBERGLASS
SOAKING TUB)

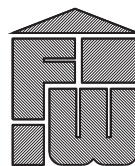

FRALIN and WALDRON, INC.
ROANOKE, VIRGINIA

"THE KESWICK" MASTER BATH
OPTIONS.